

EXTRUSION

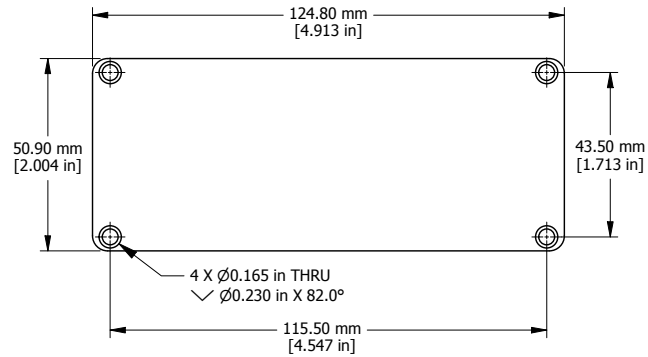

END PLATE

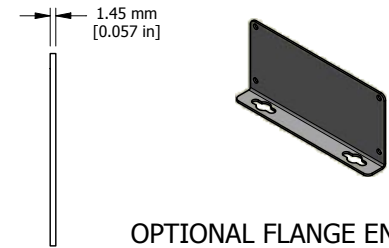

OPTIONAL FLANGE END PANEL
1455QF

EXTRUSION DESIGNED FOR 120MM WIDE PC BOARD

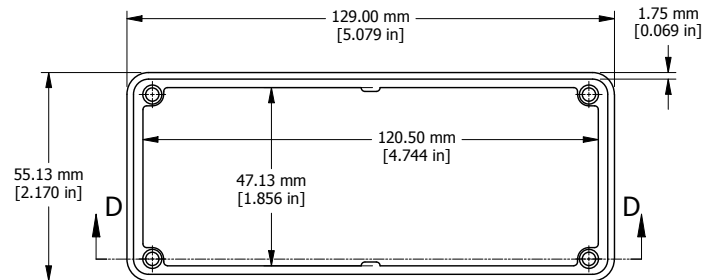

OPEN BEZEL

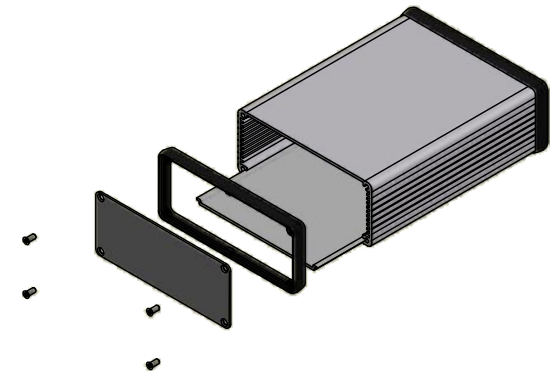
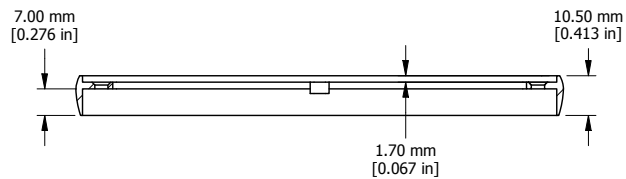

EXPLODED ASSEMBLY VIEW

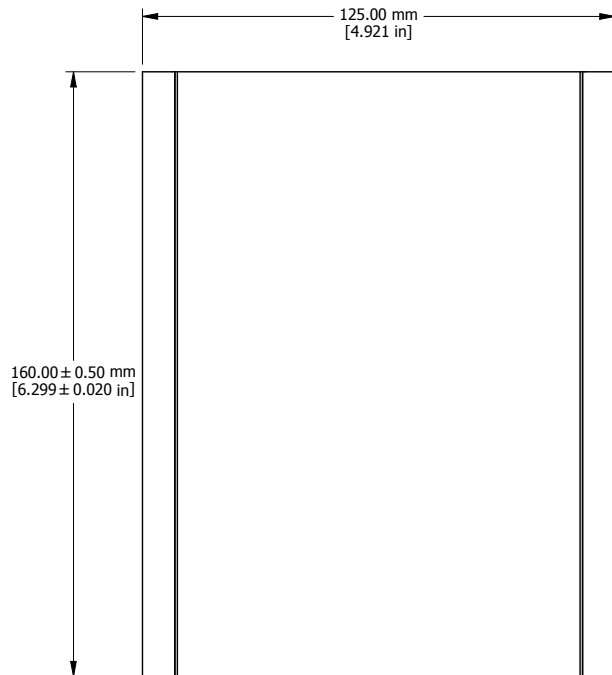

Enclosures can be Factory Modified (Milling, Drilling, Printing etc.)
Solid models of this enclosure available in STEP or IGES.
Contact Factory mjm@hammondmfg.com

NOTE	
Purchased assembly includes box, plastic bezels, end panels, #6	
Taptight screws and self adhesive rubber feet.	
Box made from Extruded Aluminum 6063.	
Bezels made with polycarbonate.	

1455Q1601	
PART NUMBERS	
Clear Anodized	1455Q1601
Black Anodized	1455Q1601BK
Blue Anodized	1455Q1601BU
Red Anodized	1455Q1601RD
ACCESSORIES	
See website for accessories.	

